

METALLIC FITTINGS

SEALTITE® FOOD GRADE FITTINGS STAINLESS STEEL AISI-316 PREMIUM NPT



DESCRIPTION

- Stainless steel AISI-316 fitting, consisting of six parts (counter nut, upper seal, clamping ring, ferrule, body and 304SS locknut).
- Special approvals: Special TPE seals, halogen free, specially formulated for food and beverage applications per FDA guideline CFR 21.
- Hygienically designed with rounded corners and a smooth contourless profile to minimize the risk of bacteria deposits and to promote easy cleaning
- Evaluated and in compliance with the current criteria for Hygienic Equipment Design of the EHEDG (report .DTU CHD DR 2017 8037-088-3) locations

SPECIFICATIONS

- AISI-316 body with AISI-304 ferrule and counter nut, TPE clamping ring and locknut
- Colour: Metallic
- Temp. range: -40° F to +221° F (-40° C to +105° C)
- cULus Approved #E234207
- IP 68 rated according EN 60529, IP 69 rated according DIN 40050-9 (till 40 Bar high pressure).
- NSF/ANSI 169

APPLICATIONS

- Rated for Food Zone Non-Contact and Splash Zone applications
- Metallic flexible conduit
- Premium Stainless 316 for the best corrosion resistance
- Compact design for tight spaces
- Suitable for hazardous locations per NEC Articles
 - 501.10 (B) (2) Class I Div. 2
 - 502.10 (A) (2) and (B) (2) Class II Div.1 & 2
 - 503.10 (A) (3) and (B) Class III Div. 1 & 2

SEALTITE®
FITTINGS

STRAIGHT:



Trade Size	Item ID	Thread ISO	Min. Int. Bore	Dimensions mm				Weight kg(lb)/100	Std. Pkg.
				A	B	C	E		
1/2"	744.016.92	M16 x 1.5	13.8	33	14	30	34	7.9 (17.4)	10
3/4"	744.020.92	M20 x 1.5	18.5	35	14	36	40	11.5 (25.4)	5
1"	744.025.92	M25 x 1.5	23.8	39	16	44	48	19.9 (43.9)	5
1-1/4"	744.035.92	M35 x 1.5	31.9	39	16	53	62	26.6 (58.6)	2
1-1/2"	744.040.92	M40 x 1.5	36.9	42	18	60	65	35.8 (78.9)	1
2"	744.050.92	M50 x 1.5	47.9	44	20	72	78	51.6 (113.8)	1

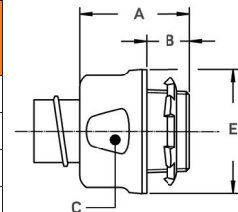

90 DEGREE:



Trade Size	Item ID	Thread ISO	Min. Int. Bore	Dimensions mm					Weight kg(lb)/100	Std. Pkg.
				A	B	C	D	F		
1/2"	744.916.92	M16 x 1.5	13.8	44	13	30	49	27	16.8 (37)	10
3/4"	744.920.92	M20 x 1.5	18.5	49	13	36	55	32	25.9 (57)	5
1"	744.926.92	M26 x 1.5	23.8	58	15	44	63	42	43.0 (95)	5
1-1/4"	744.935.92	M35 x 1.5	31.8	68	16	53	73	50	60.8 (134)	2

